

FRIDGCON®



F-23R-G / F-23F-G



F-49R-G / F-49F-G

QUALITY COMMERCIAL REFRIGERATION WITH STAINLESS STEEL INTERIOR & EXTERIOR DESIGN

Description:

- Double pane glass door for more efficient insulation
- Stainless steel 430 exterior and interior with 304 stainless steel floor ensures maximum durability
- Self-closing door with stay-open feature
- Automatic LED interior lighting
- Door lock(s) with keys
- Recessed door handles
- Heavy-duty casters with 2 front lockable Casters
- Evaporator fan delay when door opens
- Environmentally friendly
- Quicker temperature recovery
- Top rated digital temperature control system
- Oversized refrigeration system for better performance



All Fridgcon Refrigeration Equipment are ETL Certified in the US & Canada, conforms to NSF / ANSI STD 7 Food Equipment Standard Sanitation

BOTTOM MOUNT GLASS DOOR DESCRIPTION FRIDGCON BOTTOM MOUNT GLASS SERIES

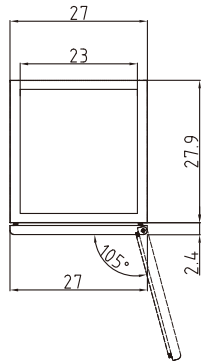

F-23R-G/F-23F-G

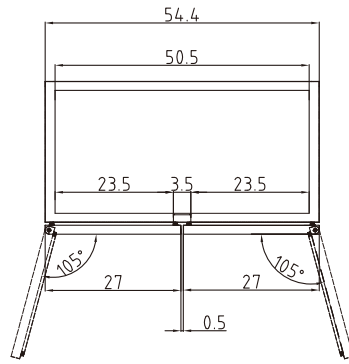

F-49R-G/F-49F-G

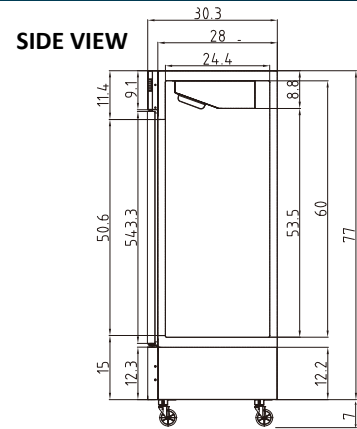

Model	F-23R-G	F-49R-G	F-23F-G	F-49F-G
Unit Type	Bottom Mount Glass Door Refrigerator		Bottom Mount Glass Door Freezer	
Number of Doors	1	2	1	2
Capacity (Cu.Ft.)	23	49	23	49
Exterior Dimensions (in) LxWxH	27x31.5x82.2	54.4x31.5x82.2	27x31.5x82.2	54.4x31.5x82.2
Interior Dimensions (in) LxWxH	22.2x25.2x60	49.7x25.2x60	22.2x25.2x60	49.7x25.2x60
Shelf Dimensions (in) LxWxH	20.9x24.4	20.9x24.4	20.9x24.4	20.9x24.4
Shelf Qty (pcs)	3	6	3	6
Net Weight	285	440	295	440
Load Capacity Per Shelf (lbs)	155	155	155	155
Voltage (v/hz/ph)	115/60/1	115/60/1	115/60/1	115/60/1
NEMA	5 - 15P	5 - 15P	5 - 15P	5 - 15P
Cord Length (ft)	8	8	8	8
Power (W)	365	590	650	1170
Power Consumption (kw/24h)	2	2.3	6.2	10
Compressor Power (hp)	1/4	1/3	1/2	3/4
Defrost Method	Air Defrost	Air Defrost	Electric Defrost	Electric Defrost
Climate Types	5	5	5	5
Refrigerant Amount (oz)	9.2	13.4	13.4	19.4
Refrigerant	R-134a	R-134a	R-404a	R-404a
Cooling Method	Ventilated	Ventilated	Ventilated	Ventilated
Temperature (°)	33° to 45°	33° to 45°	-8° to -1°	-8° to -1°
Insulation Thickness (mm)	60	60	60	60
Foaming Material	C ₅ H ₁₀	C ₅ H ₁₀	C ₅ H ₁₀	C ₅ H ₁₀
Shipping Information				
Packing Dimensions (in) LxWxH	28x32x84	55x32x84	28x32x84	55x32x84
Crated Weight (lbs)	310	520	320	530
Freight Class	150	150	150	150